

## EntryCheck E76+ with Manual Deadbolt

Indoor/Outdoor Standalone Electronic Battery Powered Solution providing controlled access for basic and multi-level high security requirements.

- » Outside Lever is Locked
- » Inside Lever is Free Egress
- » ANSI/BHMA Grade 1

**E76+** Digital Keypad Only, with Mortise Lock

**E76+P** Digital Keypad with Prox Reader, with Mortise Lock

**E76+PS** Digital Keypad with Prox Reader & Software, with Mortise Lock



## EntryCheck™ 926 Digital Keypad For Surface or Pedestal Post Mount

Outdoor stand-alone digital keypad with Privacy & Weather Protecting Housing.

- » 500 Users with PIN
- » 12-Key Illuminated, 3" x 4" Keypad
- » 4 to 6 digit code activates one or both output relays
- » WRC Series Transmitter & Receiver Compatibility
- » 12/24VDC Dual Voltage



## EP499 Explosion Proof Exit Switch

Designed for applications where flammable vapors are cause for concern, like clean room, chemical plant or refinery environments by eliminating the sparks or arc in the exit switch.

- » Impact resistant Non-Metalic Antistatic Material
- » No moving parts, maintenance free
- » 1.5" Mushroom Button (Red or Green)



## Z7600 Motorized Latch Retraction Now Available with 3 Trims!

MLR locksets ensure that the door stays latched even when unlocked, maintaining fire door integrity.

- » **Standard Trim-** Galaxy, Nova, Eclipse
- » **Single Trim-** Lever Inside Only
- » **Outside Pull Trim-** Ridgid lever, acting as pull trim when automation not necessary

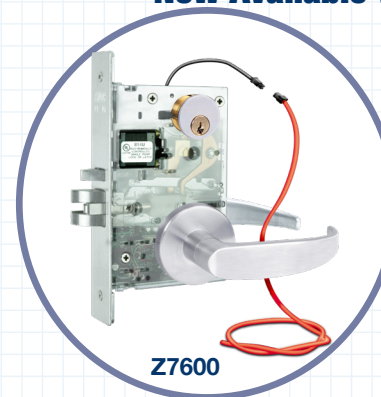

## Electra™ Pro Z7200 Cylindrical Locksets Now with Power Regulator!

- » Provides energy-efficient operation
- » Reduces power & heat used during fail-safe operation
- » Increases solenoid life

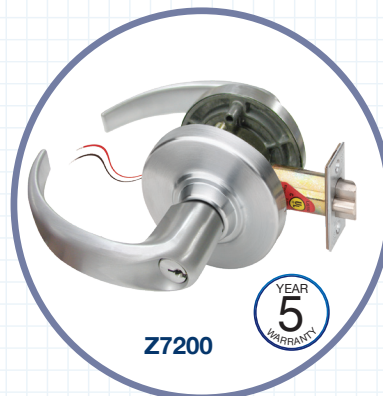

Coming Soon

## Updated Features: 1581S Mini Exit Check® Delayed Egress Lock

Now with even more features!

- » Improved Bond Alert Sensor Output
- » Improved Tandem operation for pairs of doors
- » Selectable REX on Reset operation
- » Selectable Door Prop Alarm option



# SDC EMLOCK MOUNTING ACCESSORIES

## ELECTROMAGNETIC DOOR LOCKS

**1511** Single, 1650 lbs     **1571** Single, 1200 lbs

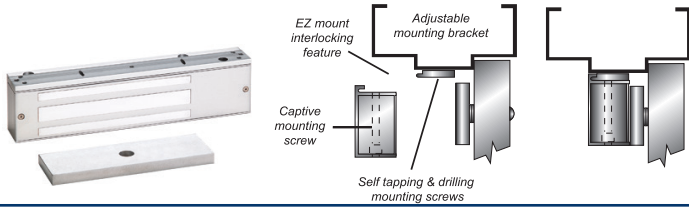

## UNIVERSAL HEADER BRACKETS

**UB11**  
Faster mounting solution!  
Save time and labor costs!



## ARMATURE MOUNTING PLATE



**AR11Y**  
Armature for doors that do not permit the use of thru bolts.

FRONT Optional DPS with AR11YD.



BACK

## DOOR COORDINATOR MOUNTING KIT

**DC-1**  
Door coordinator mounting bracket for single models.  
1511 / 1571

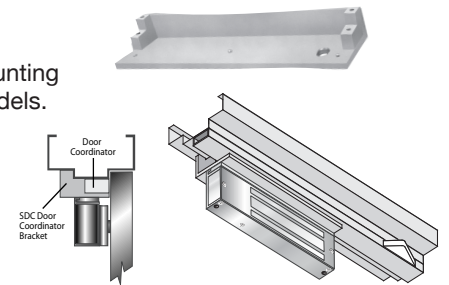

## TOP JAMB KITS

**TJ1**  
Pull side mounting for hollow metal & wood doors.

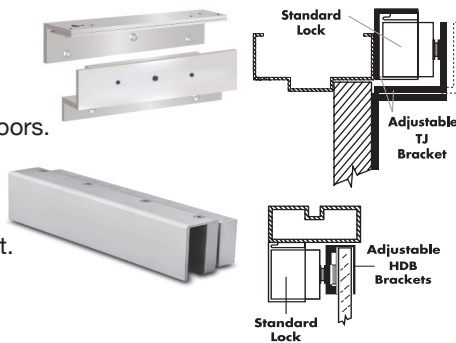

**HBD**  
Glass door mounting kit.

## FILLER PLATE ANGLE BRACKETS

Available in several sizes for a variety of frame dimensions, filler plates extend narrow stops to provide a proper mounting surface for the magnetic lock on the underside of a hollow metal frame.

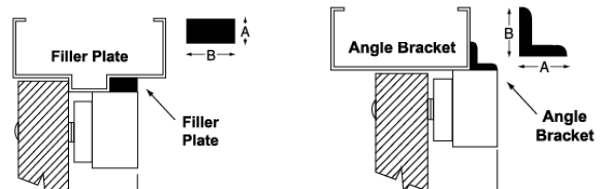

Security Door Controls Retrofit Made Easy!

Use the SDC App to send a picture with your contact information. SDC will recommend cost effective solution with product information links to retrofit the opening for access control locking hardware.

- snap a picture of your door opening application
- submit through the SDC app
- receive a complete *Electrical Access & Egress Solution*

DOWNLOAD THE FREE SDCSECURITY APP TODAY



Complete Access & Egress System Solutions

