



10B Listed For  
3 Hrs Fire Rated Doors



PTH x 5 Ft Cable



PTH x 5 Ft Cable  
And Door Position Switch

**Features**

- 5' Ft Cable
- UL10B Listed for 3 Hour Fire Rated Doors.
- 800,000 cycles. 8 times UL test criteria
- Wire Replacement Warranty

**Power Transfer Hinge Application**

Installed in the center hinge position of the door, PTH Power Transfer Hinges provide the concealed wires required to transfer power from the frame to electric hardware in the door for control and monitoring capability.

|                    |  |               |
|--------------------|--|---------------|
| <b>PTH-4Q</b>      | Four (4) Conductor Power Transfer Hinge<br>1 Amp @ 12/24V per pair<br>4.5" x 4.5" standard weight, 626 Dull Chrome   | <b>150.00</b> |
| <b>PTH-4Q-DPS</b>  | Four (4) Conductor Power Transfer Hinge with Door Status Contact<br>1 Amp @ 12/24V per pair<br>Door Status Contact: 250 mA @ 30VDC<br>4.5" x 4.5" standard weight, 626 Dull Chrome | <b>200.00</b> |
| <b>PTH-10Q</b>     | Ten (10) Conductor Power Transfer Hinge<br>1 Amp @ 12/24V per pair<br>4.5" x 4.5" standard weight, 626 Dull Chrome   | <b>195.00</b> |
| <b>PTH-10Q-DPS</b> | Ten (10) Conductor Power Transfer Hinge with Door Status Contact<br>1 Amp @ 12/24V per pair<br>Door Status Contact: 250 mA @ 30VDC<br>4.5" x 4.5" standard weight, 626 Dull Chrome | <b>250.00</b> |

**FOR VON DUPRIN ELECTRIC LATCH RETRACTION EXIT DEVICES AND OTHER HIGH INRUSH DEVICES**

The PTH-2-4 hinges have been tested with Von Duprin\* EL devices and Von Duprin power booster at Underwriters Laboratories.

|                    |  |               |
|--------------------|--|---------------|
| <b>PTH-2-4Q</b>    | <b>16 Amp Inrush</b> , 6 conductor power transfer hinge<br>1-pair 16 Amp inrush, 4 Amp continuous; 2-pair 1 Amp @ 12/24V<br>4.5" x 4.5" standard weight, 626 Dull Chrome   | <b>175.00</b> |
| <b>PTH-2-4QDPS</b> | <b>16 Amp Inrush</b> , 6 conductor power transfer hinge, <b>with door status contact</b><br>1-pair 16 Amp inrush, 4 Amp continuous; 2-pair 1 Amp @ 12/24V<br>Concealed Door Position Contact, 250 mA @ 30VDC<br>4.5" x 4.5" standard weight, 626 Dull Chrome | <b>225.00</b> |

**SPECIFY FINISH**

Dull Chrome finish is standard as specified by suffix Q.  
To specify special finish, designate finish suffix below in lieu of Q.

|                           |                                |                            |            |
|---------------------------|--------------------------------|----------------------------|------------|
| <b>C</b> 605 Bright brass | <b>H</b> 613 Oil rubbed bronze | <b>P</b> 625 Bright Chrome | <b>N/C</b> |
|---------------------------|--------------------------------|----------------------------|------------|

PT5



Miscellaneous Fire  
Door Accessory

|             |   |              |
|-------------|---|--------------|
| <b>PT-5</b> | UL Listed Concealed Power Transfer Device, for use with all high and low current applications | <b>60.00</b> |
|-------------|---|--------------|

Also recommended for use with Von Duprin\* EL 33 and 99 series and other high inrush devices  
\*Von Duprin is a registered trademark of Ingersol Rand and Von Duprin. Not intended as endorsement.

**HIGH IN-RUSH CONCEALED POWER TRANSFER DEVICE, UL LISTED**

**DOOR CORE DRILL FIXTURE**



Available factory direct to installing dealers. Major credit cards accepted. The SDC door core drill fixture provides the best method of wire preparation for particle filled or solid wood doors to accommodate the installation of electrified locksets, exit devices and hinges. The fixture provides a guide that spans the full width of the door to help provide the most accurate drilling. Other features include:

- 3/8" drill bit included
- Drilling guide spans full door width for more accurate drilling
- Full width guide is adjustable up to several degrees from hinge stile to lock stile to accommodate lock position.
- Two 3/8" drill bit guides to accommodate both standard and extra thick doors
- Two 1/4" drill bit guides to accommodate both standard and extra thick doors

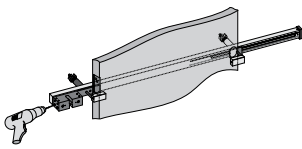

|                   |   |                   |
|-------------------|---|-------------------|
| <b>7000-IDF</b>   | Door Drill Fixture for Non-certified installers & non-fire rated door | <b>700.00 NET</b> |
| <b>7000-DF</b>    | Door core drill fixture   | <b>600.00 NET</b> |
| <b>7000-DB1/4</b> | 1/4" x 4 foot drill bit   | <b>50.00 NET</b>  |
| <b>7000-DB3/8</b> | 3/8" x 4 foot drill bit   | <b>75.00 NET</b>  |



**DOOR CORE DRILL GUIDE**



Available factory direct to installing dealers. Major credit cards accepted. The SDC door core drill guide provides the best method of wire preparation for particle filled or solid wood doors to accommodate the installation of electrified locksets, exit devices and hinges.

- Allows for drilling from the hinge side without removing the door from the frame
- Includes pilot drill

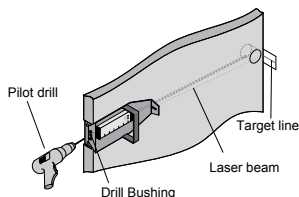

|                   |                             |                   |
|-------------------|-----------------------------|-------------------|
| <b>7000-DG</b>    | Laser door core drill guide | <b>240.00 NET</b> |
| <b>7000-DB1/4</b> | 1/4" x 4 foot drill bit     | <b>50.00 NET</b>  |
| <b>7000-DB3/8</b> | 3/8" x 4 foot drill bit     | <b>75.00 NET</b>  |



**SECURITY DOOR CONTROLS**  
801 Avenida Acaso • Camarillo, CA 93019  
Email: Service@sdcsecurity.com • www.sdcsecurity.com

Price List Effective February 15, 2009