

00500 Series

Retrofit Switch Kits

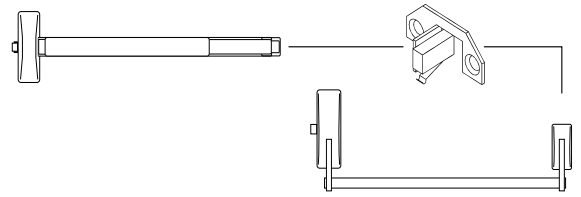

SDC's 00500 series retrofit switch kits provide electromagnetic lock release, delayed egress activation, request-to-exit (REX), alarm shunt or alarm activation.

Switch kits are field installed in the inactive hinge pad of rim mount exit devices, mortise exit devices, concealed vertical rod exit devices and surface vertical rod exit devices.

MODELS

- 00510** Von Duprin 33, 35, 98, 99
- 00510-2** Von Duprin 33, 35, 98, 99 (DPDT)
- 00510-F** Von Duprin 33, 35, 98, 99 (Fire-Rated)
- 00511** Von Duprin 55
- 00512** Von Duprin 88
- 00514** Dor-O-Matic 990, 1090, 1990, 2090
- 00515** Sargent 9300, 9400, 9500
- 00516** Sargent 9600, 9700, 9800, 9900
- 00517** Adams Rite 8300, 8400, 8700, 8800
- 00518** Precision Series 1100
- 00518A** Precision Apex 2100 - 2800
- 00519** Jackson 1095
- 00519-2** Jackson 1095 (DPDT)
- 00521** Corbin 7000
- 00525** Monarch 18, 19
- 00525-2** Monarch 18, 19 (DPDT)
- 00526** Corbin ED8200
- 00527** Sargent 80 & Arrow S3800, S120
- 00527-2** Sargent 80 & Arrow S3800, S120 (DPDT)
- 00528** Sargent 20, 60 & Yale 2100
- 00531** Yale 7000 & Corbin 4000, 5000
- 00535** Dor-O-Matic 1390
- 00536** Jackson 1295
- 00539** Cal Royal 9800
- 00540** Arrow 3000, 4000
- 00542** Hager 4700
- 00590** Dor-O-Matic 1690

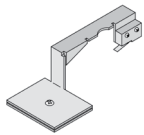

00510



00511

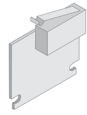

00512

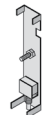

00514

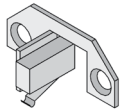

00516

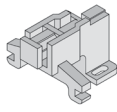

00517

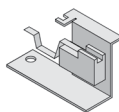

00518



00519

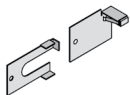

00525

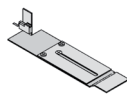

00527

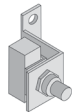

00528



SPECIFICATIONS

00500

Contact	SPDT 5 Amp @ 30 VDC Resistive
----------------	----------------------------------

HOW TO ORDER

FOLLOW STEPS FOR ORDERING

 Designates optional step

1| SPECIFY MODEL*

00510 Von Duprin 33, 35, 98, 99	00521 Corbin 7000
00510-2 Von Duprin 33, 35, 98, 99 (DPDT)	00525 Monarch 18, 19
00510-F Von Duprin 33, 35, 98, 99 (Fire-Rated)	00525-2 Monarch 18, 19 (DPDT)
00511 Von Duprin 55	00526 Corbin ED8200
00512 Von Duprin 88	00527 Sargent 80 & Arrow S3800, S120
00514 Dor-O-Matic 990, 1090, 1990, 2090	00527-2 Sargent 80 & Arrow S3800, S120 (DPDT)
00515 Sargent 9300, 9400, 9500	00528 Sargent 20, 60 & Yale 2100
00516 Sargent 9600, 9700, 9800, 9900	00531 Yale 7000 & Corbin 4000, 5000
00517 Adams Rite 8300, 8400, 8700, 8800	00535 Dor-O-Matic 1390
00518 Precision Series 1100	00536 Jackson 1295
00518A Precision Apex 2100 - 2800	00539 Cal Royal 9800
00519 Jackson 1095	00540 Arrow 3000, 4000
00519-2 Jackson 1095 (DPDT)	00542 Hager 4700
	00590 Dor-O-Matic 1690

* Consult factory for exit device switch kits not shown. Modification of any kind to a UL Listed device may void UL Listing.

STEP NUMBER: 1

ORDERING EXAMPLE: **00510**