

ELECTROMAGNETIC LOCKS



Reliable, Failsafe Security

the lock behind the system

SDC
Security Door Controls

TABLE OF CONTENTS

INTRODUCTION 3

WHY MAGNETIC LOCKS..... 4

ELECTROMAGNETIC LOCKS 5

TRADITIONAL MAGNETIC LOCKS

1510 Series [5](#)

1570 Series. [6](#)

1580 Series. [6](#)

E1200 [7](#)

E600 [7](#)

E6200 [8](#)

SPECIALTY MAGNETIC LOCKS

350 Series. [8](#)

1575/1576 [9](#)

1590 Series [9](#)

E300 [10](#)

EP17624 Series. [10](#)

ELECTROMAGNETIC SHEAR LOCKS [11](#)

1560 Series [11](#)

1562SC Series [12](#)

1561S Series [12](#)

1561TJ Series [13](#)

COMMON ELECTROMAGNETIC LOCK APPLICATIONS..... [14](#)

ADDITIONAL RESOURCES..... [17](#)

INTRODUCTION



In 1983, SDC's EMLock® design became the standard in electromagnetic locking innovation. EMLocks® were the first electromagnetic lock to feature an interlocking quick mount assembly with captive mounting screws to simplify installations. With a second-to-none complimentary offering of mounting brackets, kits and hardware, EMLocks® can meet virtually any application. It is no wonder "EMLock" is used synonymously

SDC EMLock®

for premium electromagnetic locks throughout the industry today.

Over the years, SDC's electromagnetic products offering has expanded to meet narrow header, sliding door, gate, cabinet and hazardous applications, as well as economical alternatives to imports and architectural/glass door requirements.

SDC Excel™ The Excel™ product line is designed for system integrators, distributors, installers and building owners presently using low cost import or private label brand access control hardware. Value priced Excel™ locks are economically priced, fully featured alternative to low-cost imports – providing quality and flexibility for commercial applications.

SDC HiShear® SDC's HiShear® electromagnetic shear locks are for openings that require an architecturally superior appearance. Long recognized as a cut above alternatives on the market, SDC HiShear® electromagnetic shear locks are available in concealed, semi-concealed and surface mount models.

Our U.S. factory has been retooled to build more products in-house - including electromagnetic locks – to diminish supply chain issues, increase quality control and cut lead times.

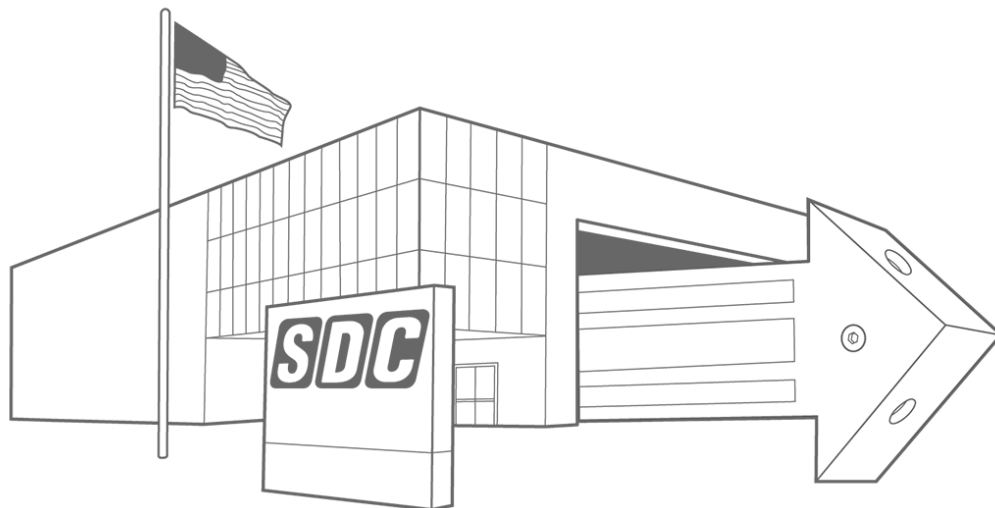

WHY MAGNETIC LOCKS

Electromagnetic locks are highly reliable and long-lasting compared to other electric locking devices because there are no moving parts involved in their operation. Life safety reliability is ensured because there is no mechanism that can cause sticking or binding. The versatility of electromagnetic locks allows them to be used almost anywhere electric strikes and electric bolt locks are used, but with these feature advantages:

- Cost effective retrofit installations
- Durability – no moving parts
- Voltage tolerance
- Minimal maintenance
- Adaptable to door misalignment

TYPES OF ELECTROMAGNETIC LOCKS, HOLDING FORCE, SECURITY AND APPLICATION

Electromagnetic locks are appropriate for interior doors, perimeter exit doors and entrances that require failsafe emergency release capability. Traditional electromagnetic locks are exposed (surface mount), whereas electromagnetic shear locks may be concealed, semi-concealed or surface mounted. Depending on the level of security required electromagnetic locks usually come in several levels of holding force.

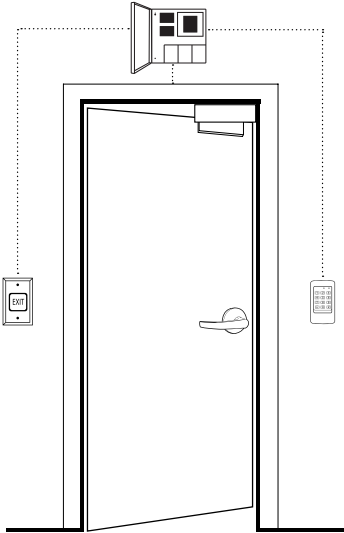

Holding Force and Security Level

Holding Force	Mag Type	Security Level
650 lbs	Traditonal	Traffic Control
1200 lbs	Traditonal	Medium Security
1650 lbs	Traditonal	High Security
2000 lbs	Shear	High Security
2700 lbs	Shear	High Security

TRADITIONAL ELECTROMAGNETIC LOCK

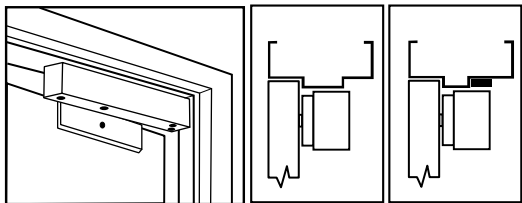

Wood Door Installation

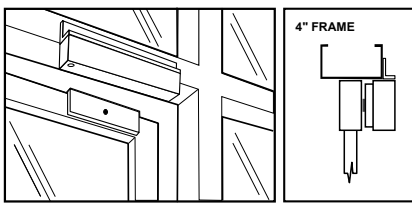

Glass Door Installation

CONCEALED ELECTROMAGNETIC SHEAR LOCK



SEMI-CONCEALED ELECTROMAGNETIC SHEAR LOCK

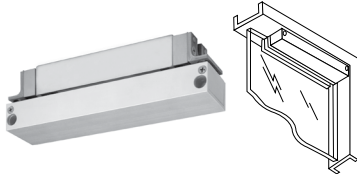

SURFACE MOUNT ELECTROMAGNETIC SHEAR LOCK

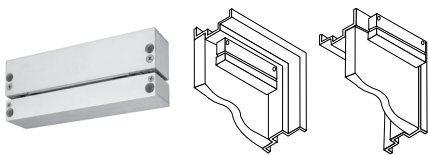

ELECTROMAGNETIC LOCKS

TRADITIONAL ELECTROMAGNETIC LOCKS

Our traditional, indoor failsafe magnetic locks include our premium EMLocks® product line models: 1510, 1570, and 1580 Series. Our Excel™ value line of economically priced magnetic includes the E1200 and the E600. The E6200 is an industrial electromagnetic lock – recommended for both interior doors and outdoor gates.

Premium EMLocks® have a variety of easy mounting features and do not require any special tools, nuts, screws or mounting hardware – making it possible for them to be installed by only one technician. They are also field upgradeable without removing them from the frame. EMLocks® are compatible with any access control system and covered by a lifetime limited warranty.

Features and Benefits

- Uniform design and installation
- Wire access chamber with terminal block
- Interlocking quick mount assembly
- Auto-sensing dual voltage
- Voltage and current spike protection
- Instant release anti-residual magnetism circuitry
- Captive lock mounting screws
- Self-drilling and tapping sheet metal screws
- 10/32" machine screws included



1510 Series

1650lb Holding Force EMLocks

SDC's 1510 series locks provide 1,650 lbs of holding force for increased security and are adaptable to virtually any application when used in conjunction with SDC's vast offering of mounting brackets, kits and hardware.



Features & Specs 1510 Datasheet

www.sdcsec.com/1510-datasheet



Part Numbers & Pricing 1510 Pricesheet

www.sdcsec.com/1510-pricesheet

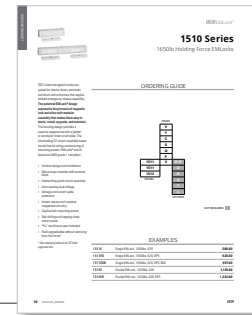

Common Part Numbers

- 1511V** Single EMLock, 1650lbs, 628
- 1511VD** Single EMLock, 1650lbs, 628, DPS
- 1511VDB** Single EMLock, 1650lbs, 628, DPS, BAS

ELECTROMAGNETIC LOCKS

SDC EMLock®

1570 Series

1200lb Holding Force EMLocks

SDC's 1570 series locks provide 1,200 lbs of holding force and are adaptable to virtually any application when used in conjunction with SDC's vast offering of mounting brackets, kits and hardware.



**Features & Specs
1570 Datasheet**

www.sdcsec.com/1570-datasheet



**Part Numbers & Pricing
1570 Pricesheet**

www.sdcsec.com/1570-pricesheet

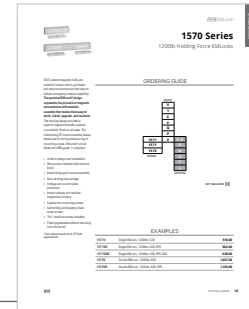

Common Part Numbers

- 1571V** Single EMLock, 1200lbs, 628
- 1571VD** Single EMLock, 1200lbs, 628, DPS
- 1571VDB** Single EMLock, 1200lbs, 628, DPS, BAS

SDC EMLock®

1580 Series

650lb Holding Force EMLocks

SDC's 1580 series locks provide 650 lbs of holding force for traffic control and are adaptable to virtually any application when used in conjunction with SDC's vast offering of mounting brackets, kits and hardware.



**Features & Specs
1580 Datasheet**

www.sdcsec.com/1580-datasheet



**Part Numbers & Pricing
1580 Pricesheet**

www.sdcsec.com/1580-pricesheet

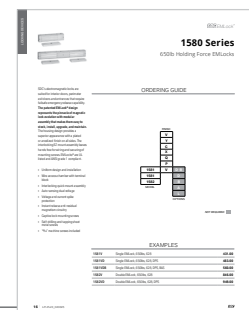

Common Part Numbers

- 1581V** Single EMLock, 650lbs, 628
- 1581VD** Single EMLock, 650lbs, 628, DPS
- 1581VDB** Single EMLock, 650lbs, 628, DPS, BAS

ELECTROMAGNETIC LOCKS

SDC Excel™

E1200

Value 1200lb Holding Force Electromagnetic Locks

Value priced E1200 locks are fully featured, easier to install and provide superior, less obtrusive architectural appearance compared to stainless steel epoxy sealed magnetic locks. Full monitoring is standard. The quick mount assembly reduces installation time compared to epoxy sealed magnetic locks.



Features & Specs E1200 Datasheet

www.sdcsec.com/E1200-datasheet



Part Numbers & Pricing E1200 Pricesheet

www.sdcsec.com/E1200-pricesheet



Common Part Numbers

E1200 Value Single Magnetic Lock, 1200lbs, 628, DBS, BAS, LED

SDC Excel™

E600

Value 600lb Holding Force Electromagnetic Locks

Value priced E600 locks are fully featured, easier to install and provide superior, less obtrusive architectural appearance compared to stainless steel epoxy sealed magnetic locks. Full monitoring is standard. The quick mount assembly reduces installation time compared to epoxy sealed magnetic locks.

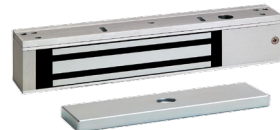

Features & Specs E600 Datasheet

www.sdcsec.com/E600-datasheet



Part Numbers & Pricing E600 Pricesheet

www.sdcsec.com/E600-pricesheet



Common Part Numbers

E600 Value Single Magnetic Lock, 600lbs, 628, DBS, BAS, LED

ELECTROMAGNETIC LOCKS

E6200

Industrial Electromagnetic Locks

E6200 locks are fully featured, made of an epoxy sealed satin stainless steel industrial housing and utilize the same mounting template as major competitive brands. Full monitoring is standard. Recommended for interior doors or outdoor gate applications.



Features & Specs E6200 Datasheet

www.sdcsec.com/E6200-datasheet



Part Numbers & Pricing E6200 Pricesheet

www.sdcsec.com/E6200-pricesheet



Common Part Numbers

E6200 Industrial Single Magnetic Lock, 1200lbs, Weatherized, 630, DBS, BAS

350 Series

Narrow Electromagnetic Locks

SDC's 350 series narrow electromagnetic locks provide 1200lbs holding force and failsafe access control for perimeter and interior doors that meet building security and fire life safety code requirements. The 350 series is specifically designed for high profile openings that require less obtrusive surface mount lock with architecturally superior appearance.



Features & Specs 350 Datasheet

www.sdcsec.com/350-datasheet



Part Numbers & Pricing 350 Pricesheet

www.sdcsec.com/350-pricesheet



Common Part Numbers

350V Narrow Single Magnetic Lock, 1200lbs, 628, DPS, BAS, LED

352V Narrow Double Magnetic Lock, 1200lbs, 628, DPS, BAS, LED

ELECTROMAGNETIC LOCKS

1575/1576

Electromagnetic Gate Locks

SDC's magnetic gate locks provide 1200lbs of holding force and enable the access and egress control of pedestrian and vehicle gates. Access controls such as card readers, digital keypads and remote control stations provide gate and lock control.



Features & Specs
1575/1576 Datasheet

www.sdcsec.com/1575-1576



Part Numbers & Pricing
1575/1576 Pricesheet

www.sdcsec.com/1575-1576-pricesheet

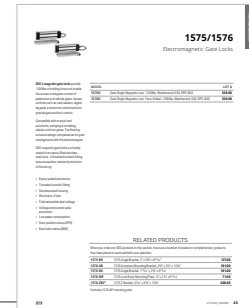

Common Part Numbers

- 1575U** Gate Single Magnetic Lock, 1200lbs, Weatherized, 630, DPS, BAS
- 1576U** Gate Single Magnetic Lock, Face-Drilled, 1200lbs, Weatherized, 630, DPS, BAS

1590 Series

Electromagnetic Sliding Door Locks

SDC's 1590 series electromagnetic sliding door locks are compact locks with 850lbs of holding power packed into a small steel mortise case. The lock is ideal for securing sliding or swinging, manual or automatic doors. Its durability for high frequency use and its mortise installation make it the choice of specification writers, owners and architects.



Features & Specs
1590 Datasheet

www.sdcsec.com/1590-datasheet



Part Numbers & Pricing
1590 Pricesheet

www.sdcsec.com/1590-pricesheet

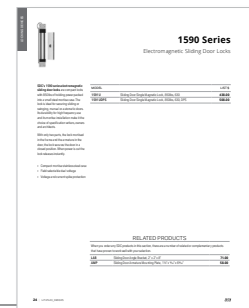

Common Part Numbers

- 1591U** Sliding Door Single Magnetic Lock, 850lbs, Weatherized, 630
- 1591UDPS** Sliding Door Single Magnetic Lock, 850lbs, Weatherized, 630, DPS

ELECTROMAGNETIC LOCKS

E300

Electromagnetic Cabinet Locks

Eliminate keys and expand the reach of access control systems to drawers, cabinets and lockers – any critical use - where the application of a compact, specialized electromagnetic lock provides a higher level of security. SDC's E300 micro electromagnetic cabinet locks provide a connected access control solution that is virtually maintenance free and has a lock status output for remote monitoring and system application needs



Features & Specs
E300 Datasheet

www.sdcsec.com/E300-datasheet



Part Numbers & Pricing
E300 Pricesheet

www.sdcsec.com/E300-pricesheet



Common Part Numbers

E300 Cabinet Single Magnetic Lock, 300lbs, 628, BAS

EP17624 Series

Explosion Proof Electromagnetic Locks



SDC's EP17624 series explosion proof electromagnetic locks are specifically designed for applications where flammable vapors are cause for concern: clean rooms, chemical plants, or refinery environments by eliminating the sparks or arc in the magnetic lock.



Features & Specs
EP17624 Datasheet

www.sdcsec.com/EP17624-datasheet



Part Numbers & Pricing
EP17624 Pricesheet

www.sdcsec.com/EP17624-pricesheet

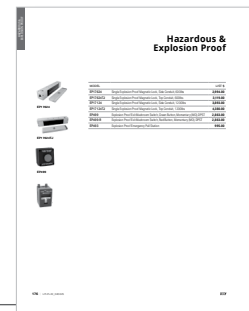

Common Part Numbers

EP17624 Single Explosion Proof Magnetic Lock, Side Conduit, 600lbs

ELECTROMAGNETIC SHEAR LOCKS

ELECTROMAGNETIC SHEAR LOCKS

SDC's HiShear® electromagnetic shear locks provide high security with a failsafe locking mechanism to meet a variety of door opening applications using commercial grade hollow metal and wood doors, metal frames, and Herculite doors with top rails.

The patented HiShear® design incorporates a floating armature assembly and special alloy steel locking tabs on both the lock and armature assemblies, that may be adjusted both vertically and laterally to compensate for wide door gaps and warped or misaligned doors. Advanced electronic circuitry incorporates a door static, alignment and timed relock sensor as well as an automatic sensing dual voltage input. Noise dampeners greatly reduce the noise associated with locking and unlocking of other shear locks on the market.

Features and Benefits

- Floating armature assembly
- Special alloy steel shear tabs
- Auto-sensing dual voltage
- Door alignment relock sensor
- Adjustable lateral and vertical alignment
- Noise dampeners

SDC HiShear®

1560 Series

Concealed Electromagnetic Shear Locks

SDC's HiShear® electromagnetic shear locks are designed, engineered and built in America for openings that require an architecturally superior appearance. Recognized as a cut above alternatives on the market, SDC shear locks provide high security with a failsafe locking mechanism to meet a variety of door opening applications.



**Features & Specs
1560 Datasheet**

www.sdcsec.com/1560-datasheet



**Part Numbers & Pricing
1560 Priceshet**

www.sdcsec.com/1560-pricesheet

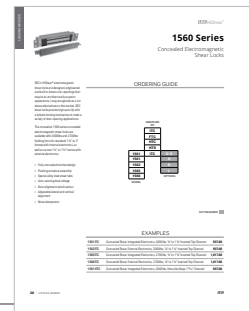

Common Part Numbers

1561ITC	Concealed Shear, Integrated Electronics, 2000lbs, 7/8" to 1 1/8" Inverted Top Channel
1562ITC	Concealed Shear, External Electronics, 2000lbs, 7/8" to 1 1/8" Inverted Top Channel
1565ITC	Concealed Shear, Integrated Electronics, 2700lbs, 7/8" to 1 1/8" Inverted Top Channel

ELECTROMAGNETIC SHEAR LOCKS

SDC HiShear®

1562SC Series

Semi-Concealed Electromagnetic Shear Locks

SDC's 1562SC series semi-concealed configuration incorporates the innovative HiShear® concealed electromagnetic lock with a surface mounted armature assembly. The semi-concealed design also provides the advantage of mounting the HiShear® on the secure side of the door opening, eliminating potential for tampering.



**Features & Specs
1562SC Datasheet**

www.sdcsec.com/1562SC-datasheet



**Part Numbers & Pricing
1562SC Pricesheet**

www.sdcsec.com/1562SC-pricesheet



Common Part Numbers

- 1562SCV** Semi-Concealed Shear, External Electronics, 2000lbs, 628
- 1562SCHDB** Semi-Concealed Shear, 1/2" Glass Door Shear Lock, External Electronics, 2000lbs, 628
- 1562SCHDB3/4** Semi-Concealed Shear, 3/4" Glass Door Shear Lock, External Electronics, 2000lbs, 628

SDC HiShear®

1561S Series

Surface Electromagnetic Shear Locks

SDC's HiShear® electromagnetic shear locks are designed, engineered and built in America for openings that require an architecturally superior appearance. Recognized as a cut above alternatives on the market, SDC shear locks provide high security with a failsafe locking mechanism to meet a variety of door opening applications.



**Features & Specs
1561S Datasheet**

www.sdcsec.com/1561S-datasheet



**Part Numbers & Pricing
1561S Pricesheet**

www.sdcsec.com/1561S-pricesheet

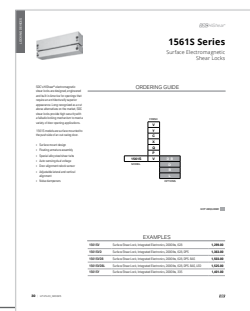

Common Part Numbers

- 1561SV** Surface Shear Lock, Integrated Electronics, 2000lbs, 628
- 1561SVD** Surface Shear Lock, Integrated Electronics, 2000lbs, 628, DPS
- 1561SVDB** Surface Shear Lock, Integrated Electronics, 2000lbs, 628, DPS, BAS

ELECTROMAGNETIC SHEAR LOCKS



1561TJ Series

Surface Top Jamb Electromagnetic Shear Locks

1561TJ models are surface mounted to the pull side of an in-swing door. For metal door and frame, glass door with top rail and metal frame, or wood door and frame. This mounting configuration eliminates the need for cumbersome and unsightly top jamb Z brackets normally associated with pull side mounting of magnetic locks.



Features & Specs 1561TJ Datasheet

www.sdcsec.com/1561TJ-datasheet



Part Numbers & Pricing 1561TJ Priceshet

www.sdcsec.com/1561TJ-pricesheet

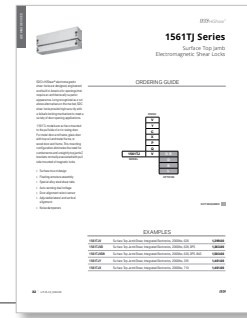

Common Part Numbers

- 1561TJV** Surface Top Jamb Shear, Integrated Electronics, 2000lbs, 628
- 1561TJVD** Surface Top Jamb Shear, Integrated Electronics, 2000lbs, 628, DPS
- 1561TJVDB** Surface Top Jamb Shear, Integrated Electronics, 2000lbs, 628, DPS. BAS

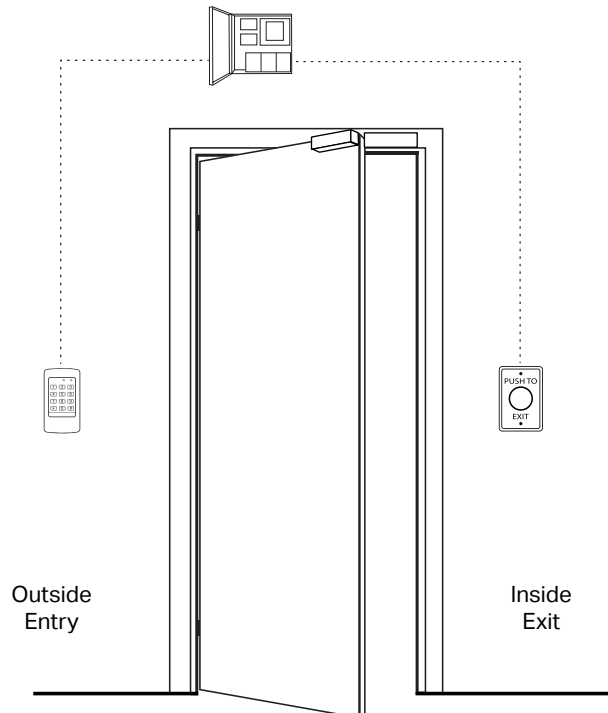

COMMON APPLICATIONS



Access & Egress Security Solutions Brochure

Common electromagnetic lock application solutions can be found on pages 12, 13, 14, 22, 27, 29, 32-34, and 36.



www.sdcsecurity.com/Solutions-Brochure

Magnetic Lock Access Control

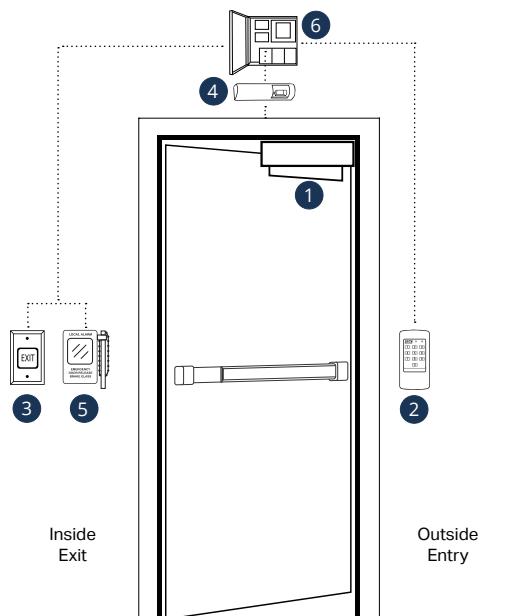

Access & Egress Security Solutions Brochure Page 12

Magnetic Lock Value Access Control

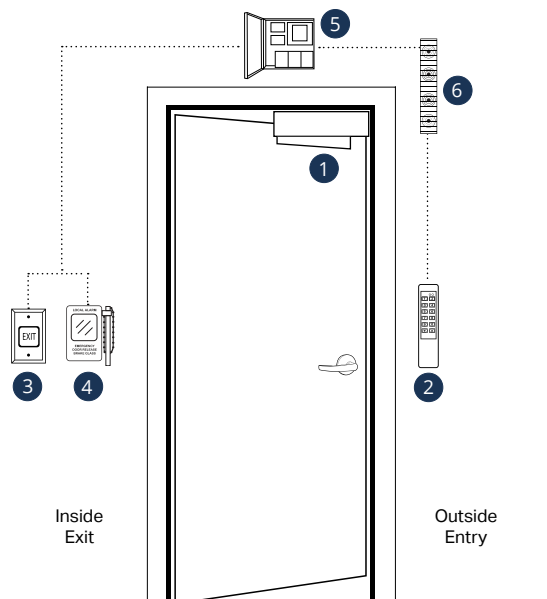

Access & Egress Security Solutions Brochure Page 13

COMMON APPLICATIONS

Automated Magnetic Lock Access Control

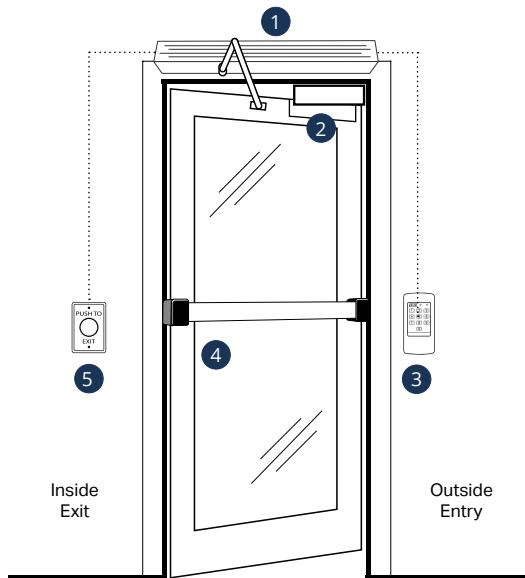

Access & Egress Security Solutions Brochure Page 14

Spark Explosion Prevention

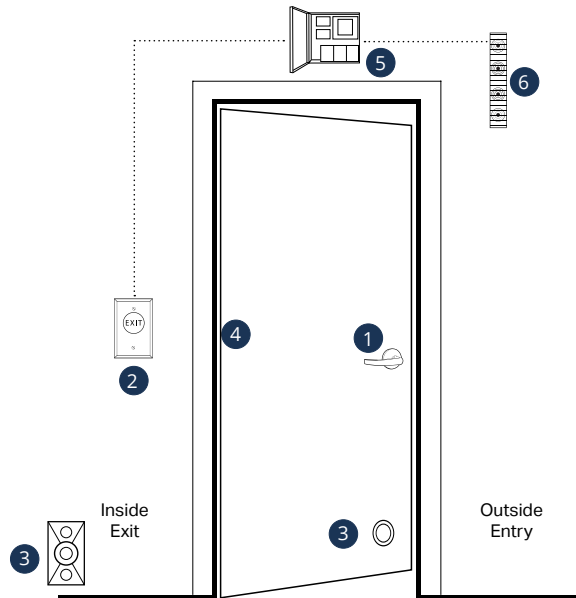

Access & Egress Security Solutions Brochure Page 22

Public Park Restroom Facilities

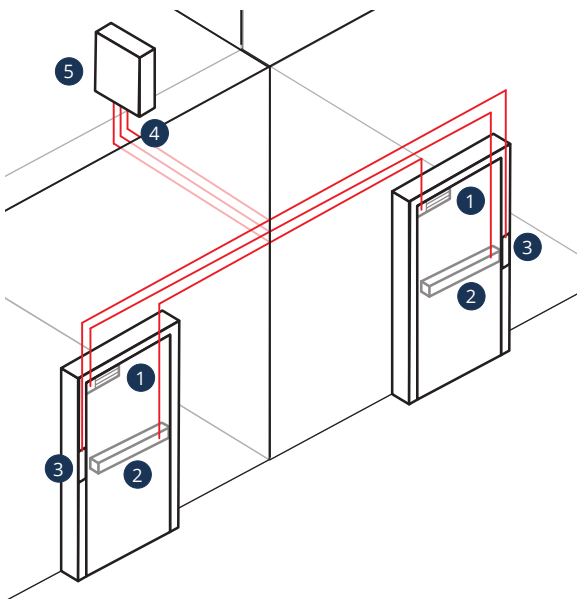

Access & Egress Security Solutions Brochure Page 27

Outdoor Gate Control

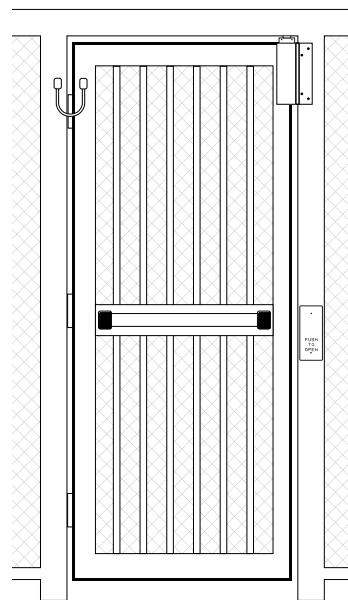

Access & Egress Security Solutions Brochure Page 29

COMMON APPLICATIONS

24 Hour Facility Access

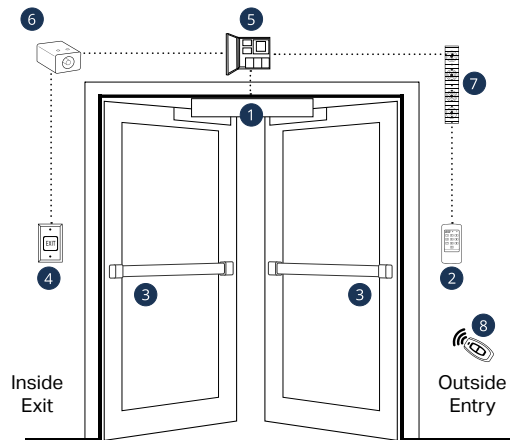

Access & Egress Security Solutions Brochure Page 32

Convenience Store Entrances

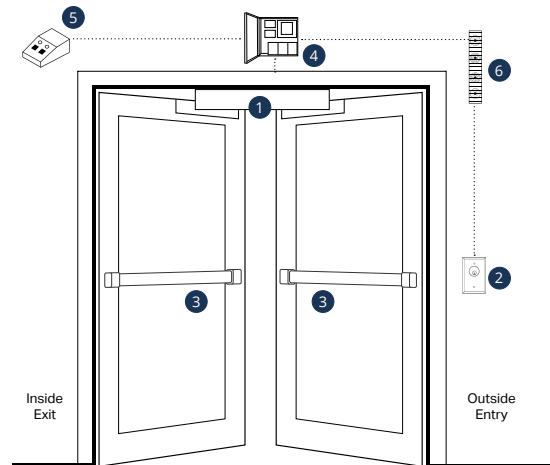

Access & Egress Security Solutions Brochure Page 33

Narrow Header Glass Door Entrances

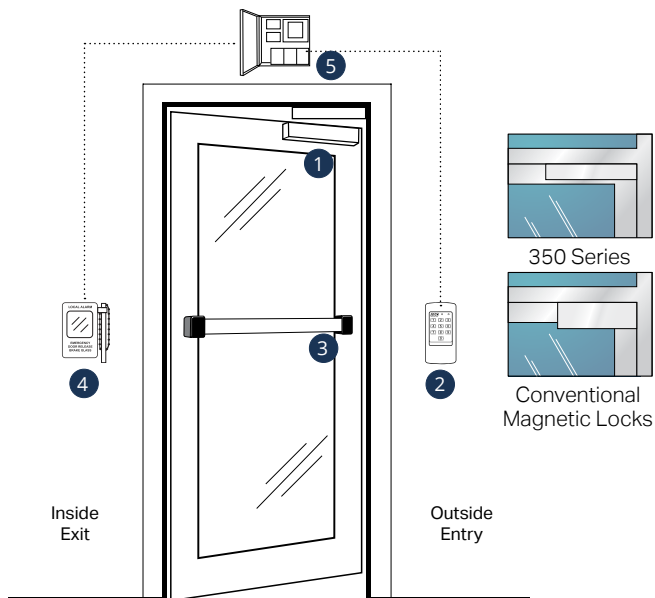

Access & Egress Security Solutions Brochure Page 34

Simple Storefront Control

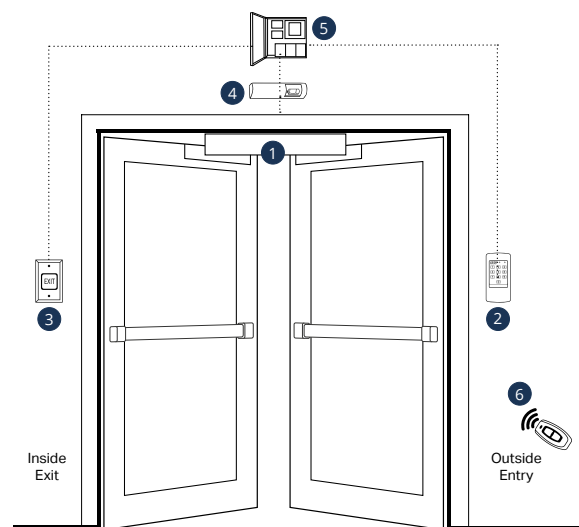

Access & Egress Security Solutions Brochure Page 36

ADDITIONAL RESOURCES

Complementing our premier line of electromagnetic lock solutions is the industry's most comprehensive suite of accessories – for meeting safety, security, and compliance requirements with flexibility and customization not found in other brands. **See related products on any electromagnetic lock solutions product datasheets for applicable accessories.**



FILLER PLATES

For extension of the stop to provide a proper mounting surface on the underside of the header.

ANGLE BRACKETS

Used as extension on shallow door frames to provide adequate mounting surface.

TOP JAMB MOUNTING KITS

Accommodate the installation of a standard magnetic lock to the pull-side of hollow metal door openings.

GLASS DOOR MOUNTING KITS

Accommodate the installation of the lock armature assemblies to glass doors without top rails. Field adjustable for $\frac{1}{2}$ ", $\frac{5}{8}$ " and $\frac{3}{4}$ " glass herculite doors.

SPACER BRACKETS

For aluminum frames with blade stop and concrete filled hollow metal frames. SDC's spacer bracket lowers the lock below blade stop to ensure proper function in aluminum frames and provides multiple points for concealed wire entry in concrete filled hollow door frames.

HEADER BRACKETS

Used in lieu of angle brackets, SDC's header brackets provide a faster mounting solution with a machined wire chase, pre-drilled and countersunk holes for frame mounting, and pre-drilled and tapped holes for lock mounting.

ARMATURE MOUNTING PLATES

Accommodate the installation of magnetic lock armature to the top rail of herculite, aluminum and glass, wood and hollow metal doors that do not permit the use of thru bolts.

DOOR COORDINATOR BRACKETS

Designed for use on pairs of doors when one door needs to close before the other in proper order for latching to occur. SDC's door coordinator brackets prevent the inadvertent disabling of the coordinator.

REUSABLE DRILL FIXTURES

Reusable heavy duty drill fixtures for SDC electromagnetic lock installations.

ADDITIONAL RESOURCES

Electromagnetic Locks Landing Page



www.sdcsec.com/magforce

Electromagnetic Locks White Paper



www.sdcsec.com/whitepapers-emlocks

EMLock® Install Overview Video

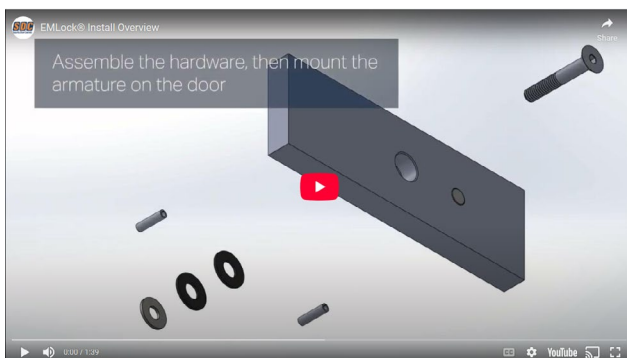

www.sdcsec.com/EMLock-install

Magnetic Lock Mounting Illustrations Video



www.sdcsec.com/EMLock-install-illustrate

Need Help Building Your Solution?

Use **DoorSnap™** in the free **SDC App** for your door retrofit projects



SDC Solution Experts Will Craft Personalized Solutions For You!

- 1 Open the SDC App and select DoorSnap™
- 2 Take a photos of your door opening
- 3 Submit photos of your door opening
- 4 Receive a complete access and egress electrified solution

Download the FREE SDCSecurity App now!

Our award-winning app includes labor-saving DoorSnap™ functionality. SDC will recommend a cost effective solution with product information links to retrofit the opening for access & egress control locking hardware.



