

# Hands Free ADA Compliant Access Control

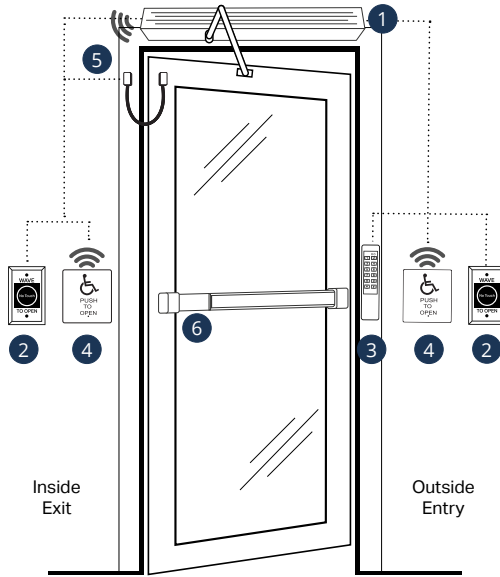

## 1 AUTO Series

### Low Energy Swing Door Operators

AUTOS136V	Push Arm, 36" Opening
AUTOS236V	Pull Arm, 36" Opening
AUTO-IR36Y	Presence Sensor



- Single button, self-tuning setup
- Built-in 1 Amp power supply
- Onboard lock sequencing

## 2 470 Series

### No Touch Switches

474U	Single Gang
474DU	Double Gang
474MU	Single Gang, Manual Override



- WAVE-TO-OPEN
- IR sensing technology
- Illuminated dual LED sensor (red/green)

## 3 923 Series

### Indoor/Outdoor Digital Keypads

923	Self Contained
923P	Self Contained w/Prox
923PW	Weigand Output



- Narrow surface, mullion or frame mount
- Heavy cast vandal resistant housing
- 500 users

## 4 480-KIT Series

### Wireless Push Plate Kits

482S-KIT	Square Plates
482R-KIT	Round Plates
482S-CBCKIT	Square High-Low Plates



- SPDT push plates
- Surface mount boxes
- Wireless transmitters and receiver

## 5 PT Series

### Power Transfer Loops

PT-3V	Surface
PT-3/8V	Surface, 3/8" ID
PT-5	Concealed Mortise



- Flexible steel conduit

## 6 S5000 Series

### Electrified Storefront Exit Devices

S5101PV36RE	Rim, 36", 628 Finish
S5101PY36RE	Rim, 36", 335 Finish
S5801PV36RE	CVR, 36", 628 Finish



- Motorized electric latch retraction
- Storefront design