

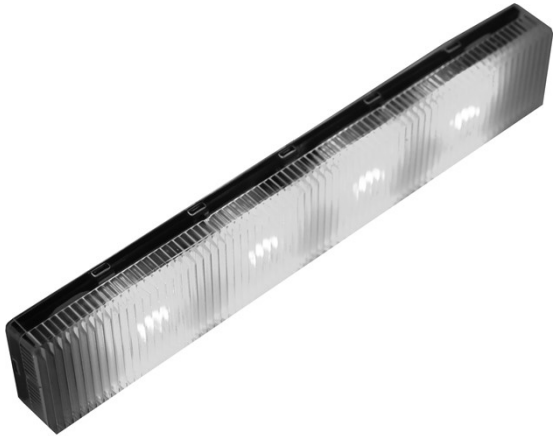

# INSTALLATION INSTRUCTIONS

## EA100 EXIT ANNUNCIATOR



**The SDC Exit Annunciator** is a highly visible multi-color signal device that interfaces with Delayed Egress or standard EMLocks plus many other manufactures electromagnetic locks. It can also be wall ,ceiling or frame mounted. The EA100 may also be connected to other devices to serve as an external visual indicator .

### Features:

- Easy to install
- Suitable for retrofit or new construction
- Multi color LED technology
- Externally selectable color modes of RED, Green, Blue, White, Yellow and Purple.
- Externally selectable Solid or Flashing modes.

### Specifications:

#### Dimensions:

8-3/4" X 1-1/2" X 3/4"

#### Electrical:

12/24VDC @ 80/100mA Max.  
Power

Long life LED output:

3 Primary colors, Red,

Blue, Green (solid or chasing)

### Operation:

Applying 12vdc or 24vdc power and activating a control wire will turn on the associated primary color (Red, Green, Blue). Activating two colors at the same time will produce secondary colors (Violet, Yellow ,Blue/ Green) . Activating all three colors will produce White. Activating the Chase wire will cause the color(s) that are selected to flash.

## APPLICATIONS

Ceiling Mount

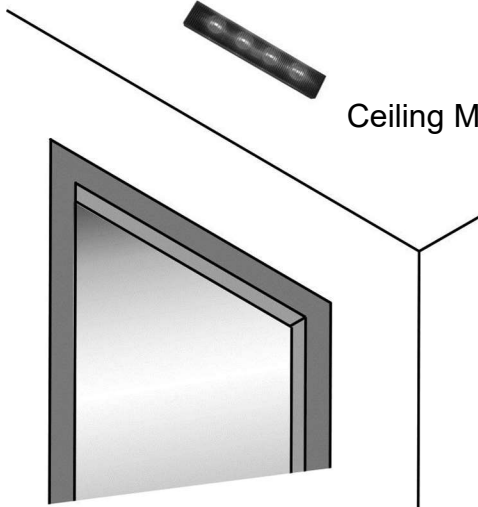

Frame Mount

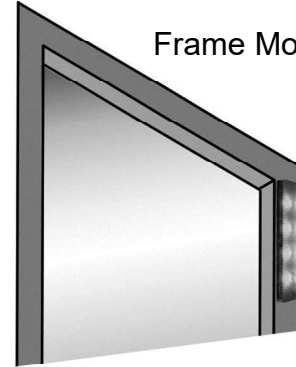

Wall Mount

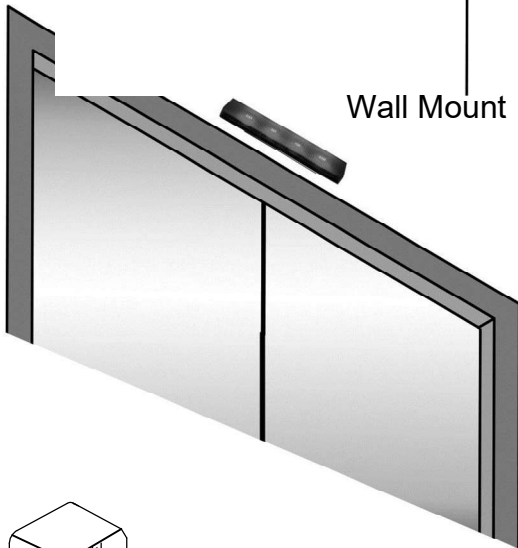

Lock Mount

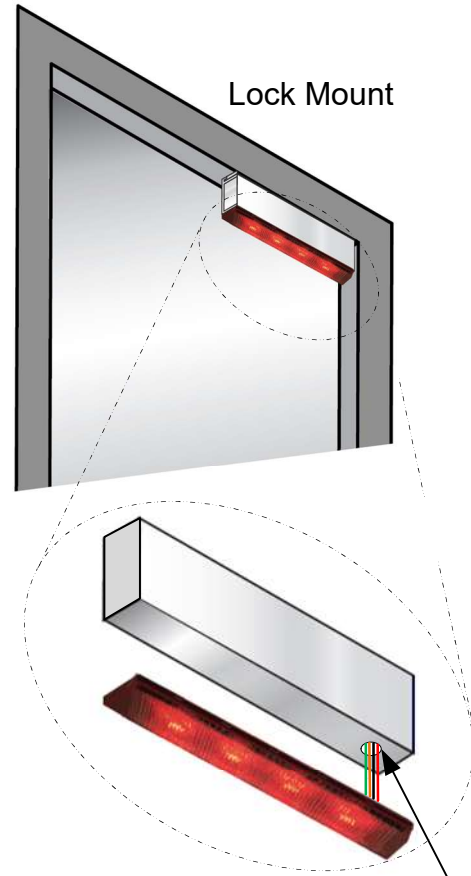

OPTIONAL MOUNTING

Single Gang Box

Single Gang Plate

Base

Circuit Board

Lens Cover

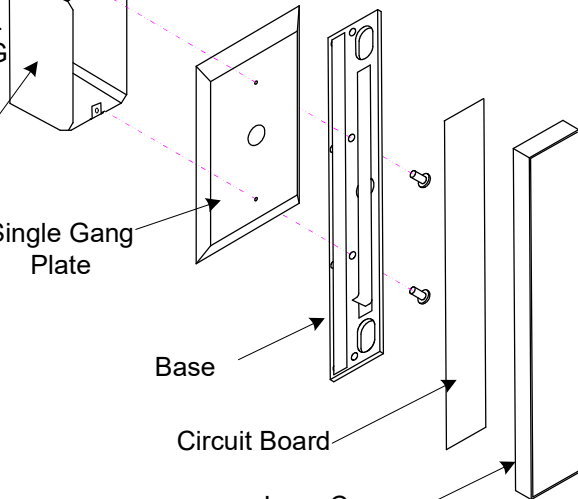

Drill hole into junction area for power wire routing and all LED connections

Use double sided tape or screws to mount bracket in your selected location or on an magnetic lock. Snap EA100 circuit board onto mounting bracket. Connect wiring then install lens cover and EA100 Cover.

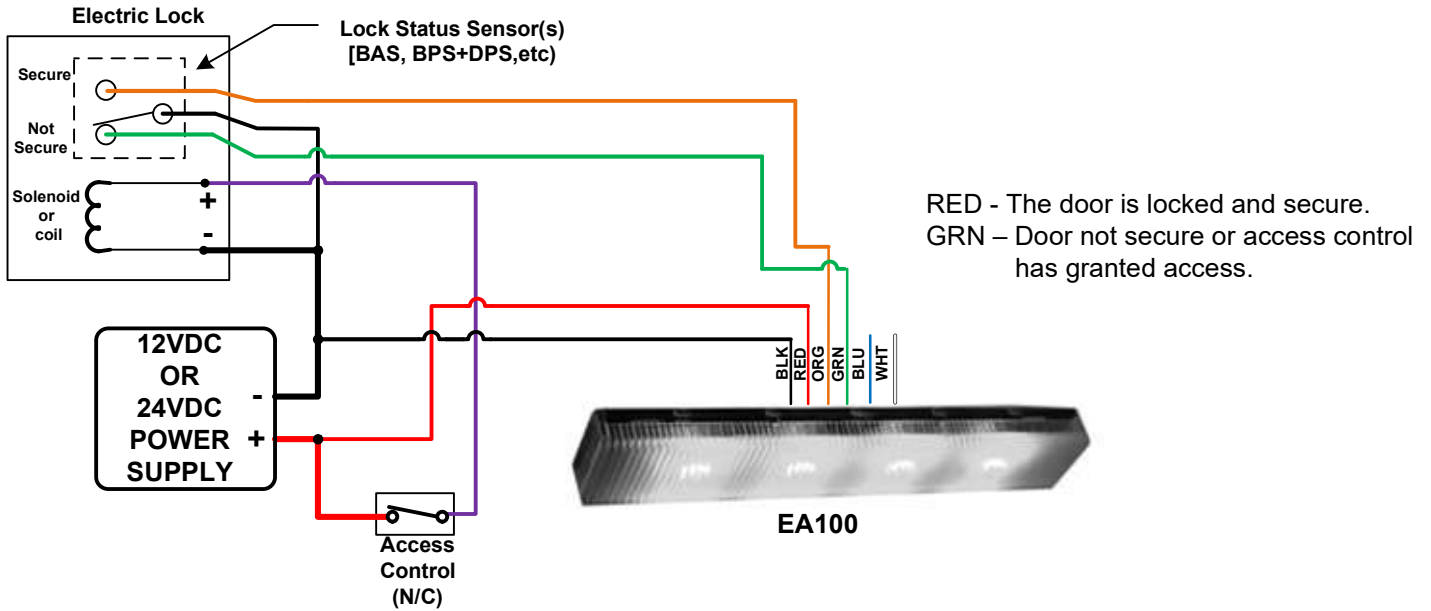

**Fig. 1**

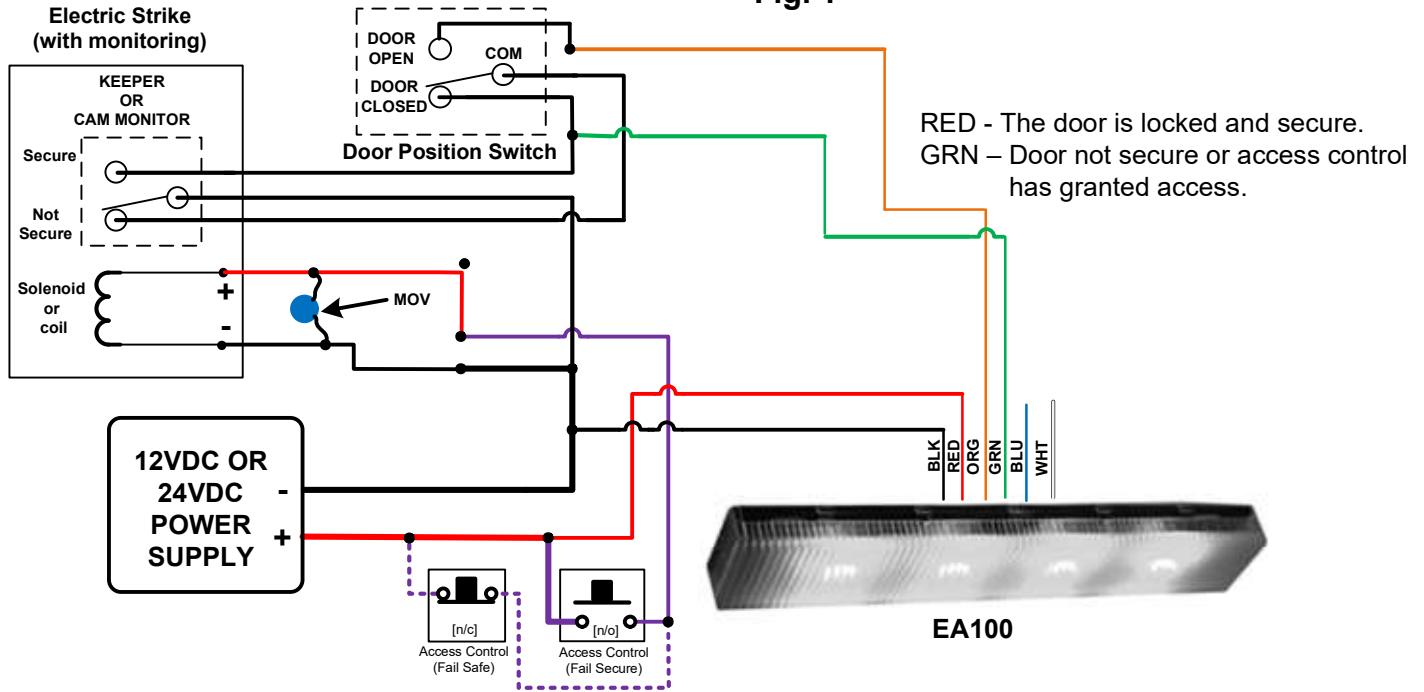

**Fig. 2**

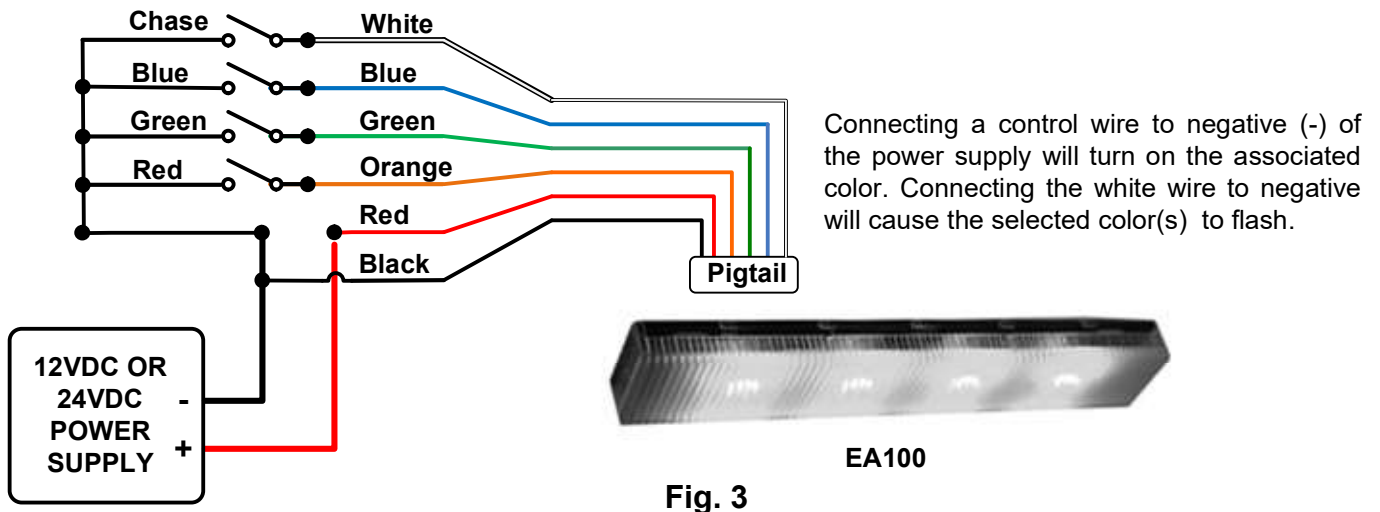

**Fig. 3**

# Typical Delayed Egress Applications

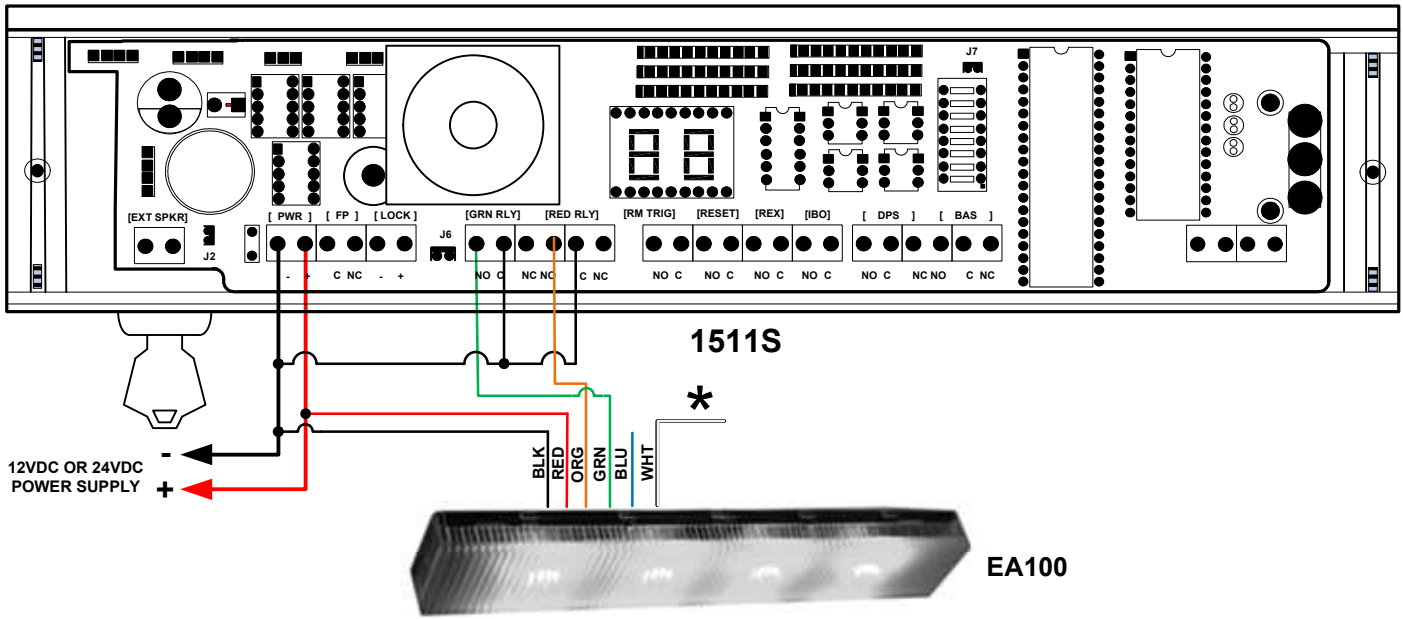

Fig. 4



## EA100 Operation

Green - The door is locked and secure.

Amber - The unit is in the alarmed countdown cycle.

Red - The unit is in alarm and the door is unlocked.

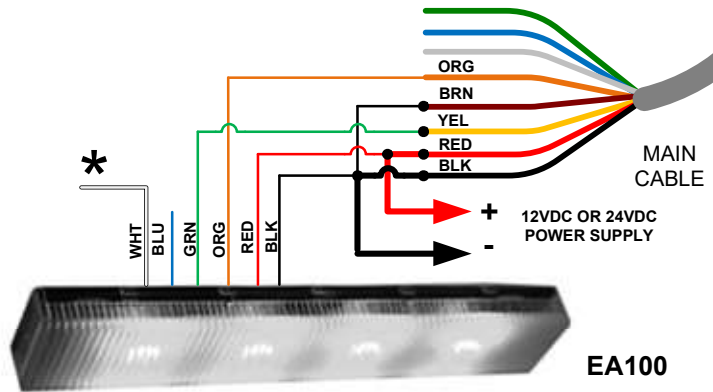

Fig. 5

**\***

### Note:

Both the Orange and White wire can be wired to the same connection for enhanced visibility.

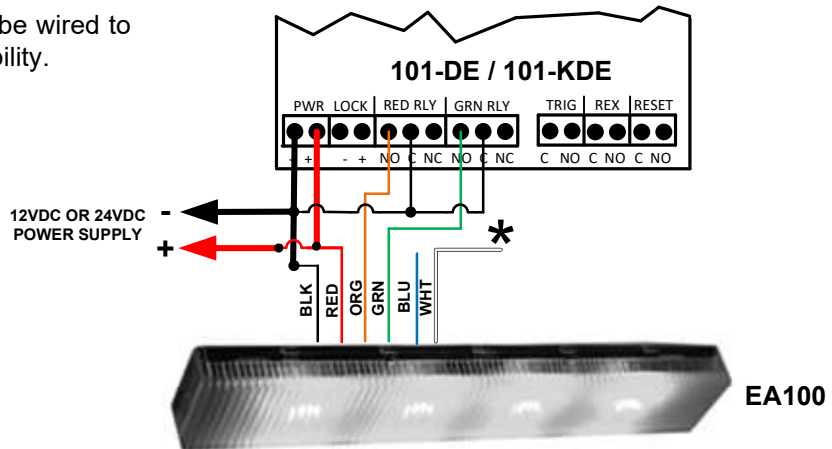

Fig. 6