



# INSTALLATION INSTRUCTIONS

## LR100DXK DETEX ELECTRIC LATCH RETRACTION DEVICE KIT MODELS: 10, 20, 40, 50, 60 & 80 SERIES

**Retrofit Installation Note:** 42" or 48" exit devices that have been modified to fit a 36" or smaller opening, may not have the required space to fit the standard E. L. R. assembly. Always verify the distance from the end of the touchpad to the end rail, and if necessary, consult with the factory for appropriate selection.

### STEP 1

Carefully remove the Cover, End Cap and End Cap Mounting Plate. If present, remove existing Dogging. Slide Pushpad assy. out of the Extrusion and Inner Sleeve.

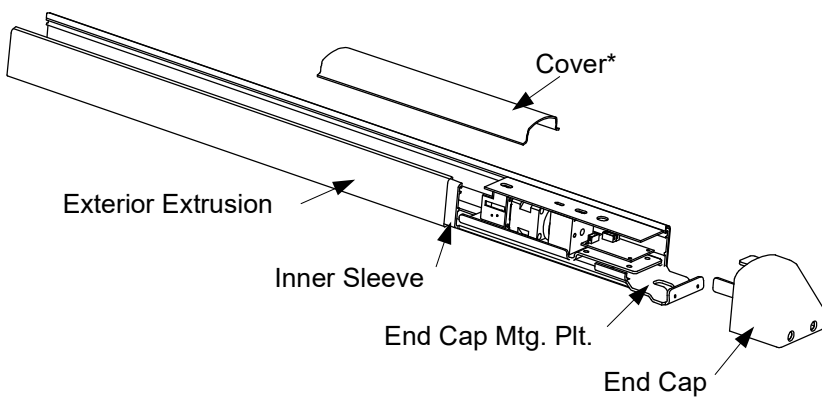

\*Value Series REQUIRES a modified cover; either order Detex Part #100518-11 or modify existing cover per page 2

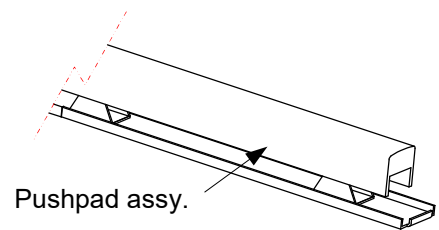

### STEP 2

Install the linkage from the bottom of the Pushpad assy. Place the spacer over the existing tapped hole inside the base where shown. Carefully place the screw and washer over the linkage and spacer and tighten into the Pushpad base.

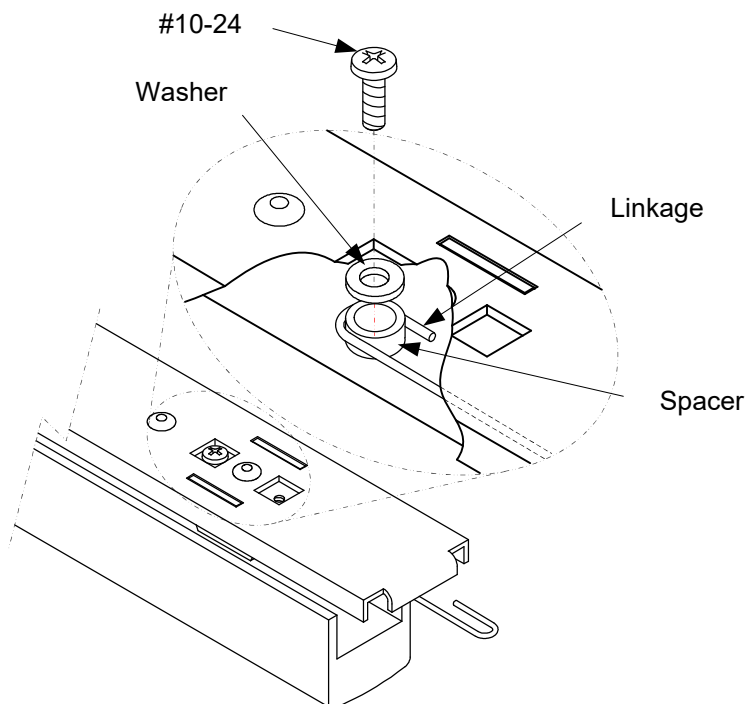

Any suggestions or comments to this instruction or product are welcome. Please contact us through our website or email [engineer@sdsecurity.com](mailto:engineer@sdsecurity.com)



**STEP 3**

Re-install Pushpad assy. Slide the LR100DXK into the device and attach the linkage to the clevis. Back the assembly out until the linkage JUST makes contact with the clevis. Secure in place with the two #8-32 socket set screws supplied. Wire the unit to power and replace the Cover, End Cap Mounting Plate and End Cap.

Back assembly out until the linkage JUST makes contact with the clevis

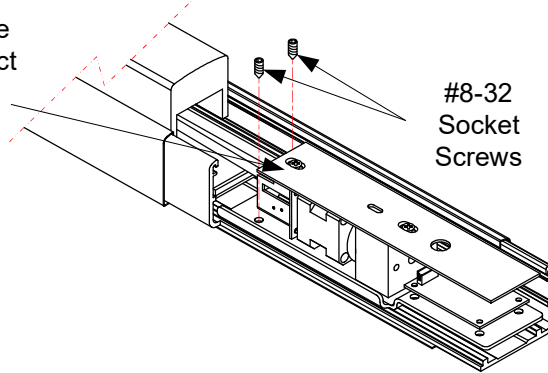

#8-32 Socket Screws

**ELECTRICAL DATA**  
24VDC @ 700/200mA  
RED (+) BLK (-)  
PATENT #8,851,530

Value Series Existing Cover Modification

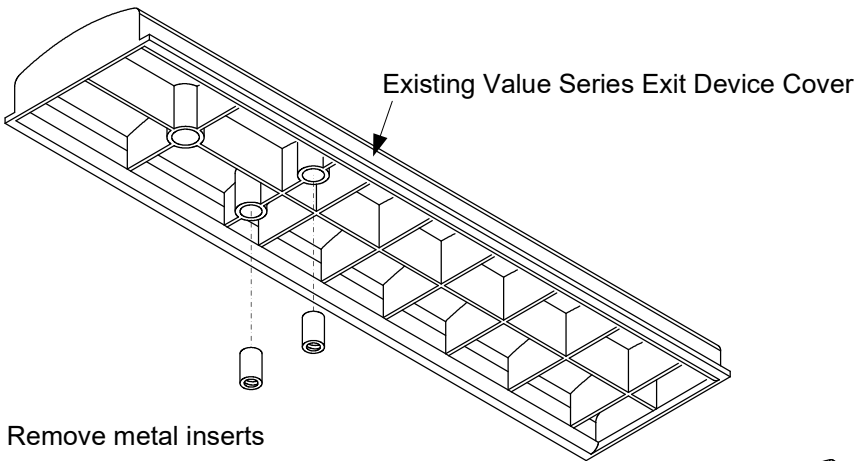

Existing Value Series Exit Device Cover

Remove metal inserts

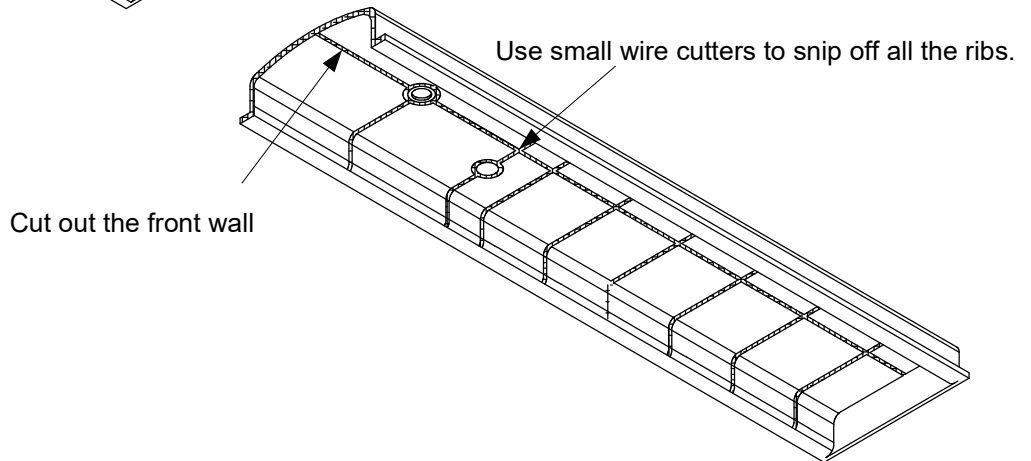

Use small wire cutters to snip off all the ribs.

Cut out the front wall

When retrofitting to existing vertical rod devices, adjustment of the rods is required for proper operation of the Electric Latch Retractor. Once the unit is properly installed, energize it so the latch is dogged down, then reconnect the vertical rods to the device and make the proper adjustments.