

# SDC Security Door Controls

801 Avenida Acaso, Camarillo, Ca. 93012 • (805) 494-0622 •  
www.sdcsecurity.com • E-mail: service@sdsecurity.com

## INSTALLATION INSTRUCTIONS Z7700 SERIES MOTORIZED RETRACTION x ELECTRIC SOLENOID MORTISE LOCK SET

### A. Door Preparation:

1. Measure desired height from finished floor, mark a horizontal line on door and door edge.
2. Align template on edge of door with applicable horizontal at height line. Check the chart for drilling trim holes on template and mark only holes for lock function being installed.

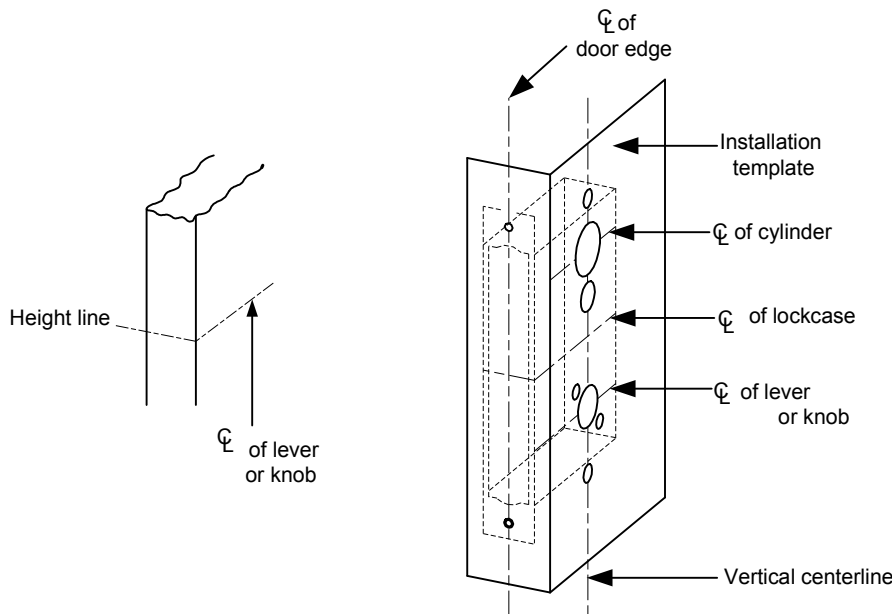

\* NOTCH OPENING FOR MOTOR ON WOOD DOORS ONLY

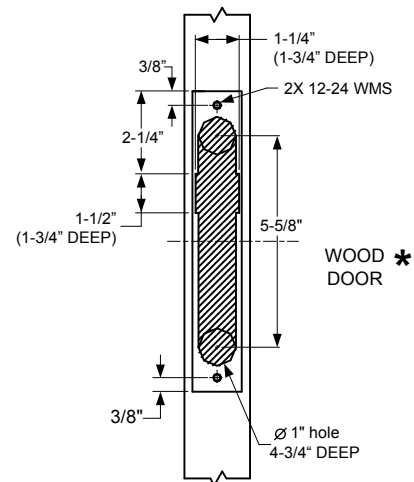

3. Mortise door edge according to measurements on installation template and drill proper holes for trim.
4. Recess for face plate, the dimension is:  
L 8-1/32" x W 1-5/16" x D 7/32".
5. Route wiring through door as required. Reference wiring section on Page 4

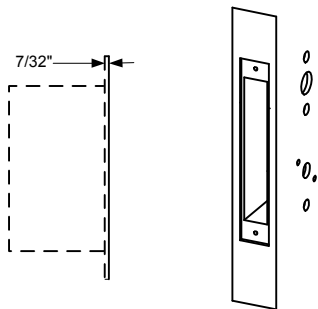

### B. Strike Installation:

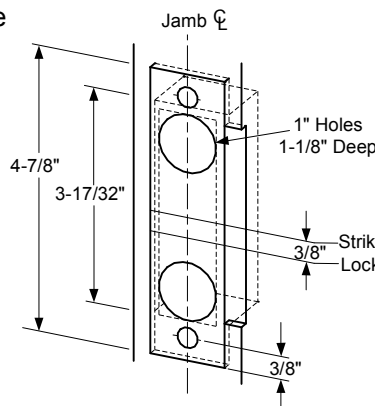

1. Align strike template on jamb. Be sure to keep 3/8" distance between lock centerline and strike centerline. Recess 5/32" for flush fit of strike and dust box.
2. Mortise jamb according to measurement of strike template. Then fit strike and dust box into frame and secure into place with supplied screws.

Any suggestions or comments to this instruction or product are welcome. Please contact us through our website or email engineer@sdsecurity.com

## C. Install Lockcase

### Instructions for changing lock hand:

#### 1. Change latchbolt handing:

If the hand of the latchbolt doesn't match the door hand, remove the fixing screw and pull the latchbolt out from lock case. Turn the latchbolt 180° to change the handling. Position latchbolt back, into case and re-fasten it.

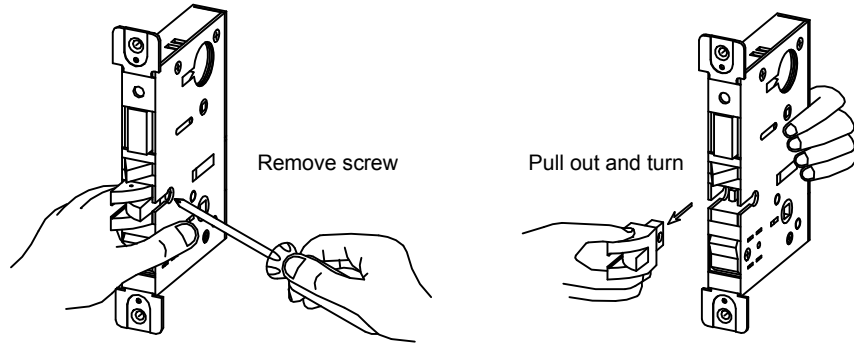

2. Connect wires as shown in the lock wiring section on page 4.

3. Insert lockcase into mortise cut-out and fasten screws to door.

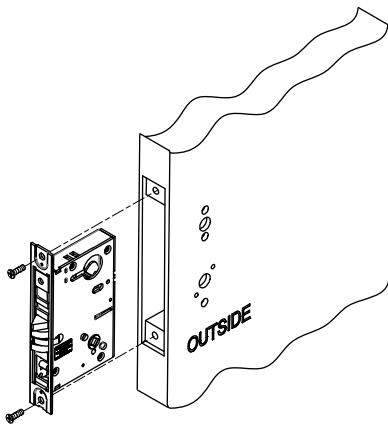

## E. Install Lever trim

1. Place the reversible spring cage onto the ferrules with arrow pointing in direction of lever rotation.
2. Install outside trim with mounting posts through door and position lever onto the spindle.
3. Install inside spring cage onto the spindle with the arrow pointing in the direction of inside lever rotation.
4. Install inside mounting plate onto spindle. Tighten with provided screw.
5. Cap inside rose over mounting plate.

## D. Install Spindles

1. Insert spindles as shown

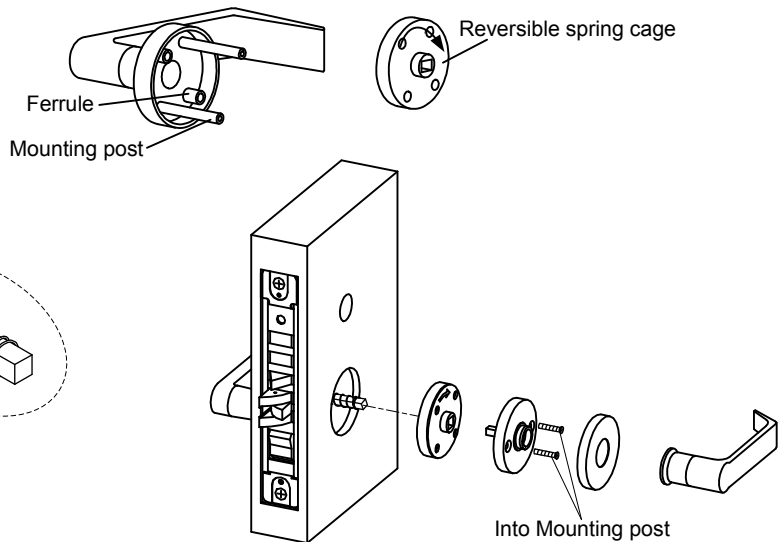
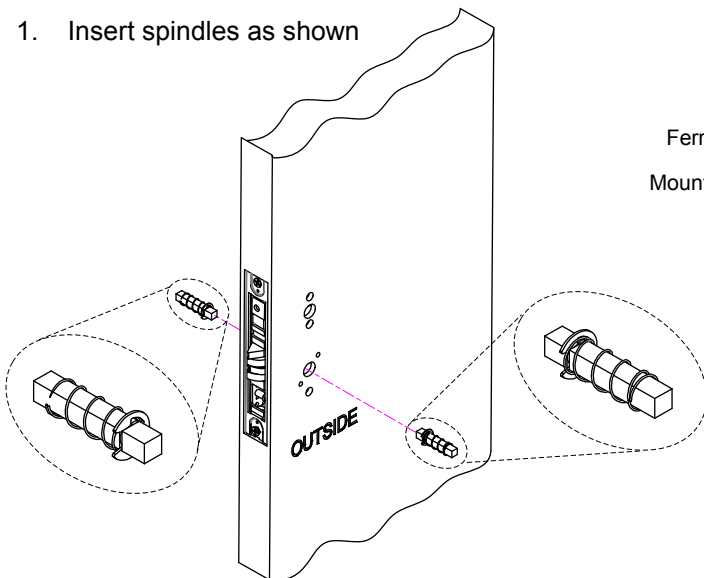

### E. Install Lever trim (continued)

6. Screw inside lever into position and tighten lever collar with supplied spanner wrench.

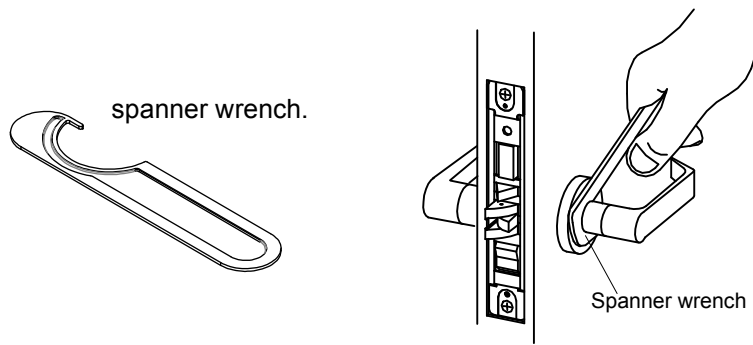

### F. Install Cylinder and Armor Face Plate

1. Screw cylinder into threaded hole of lock case.
2. Tighten the setting screw against cylinder(s) by turning clockwise as shown.
3. Install face plate onto lock case front and fasten with supplied screws.

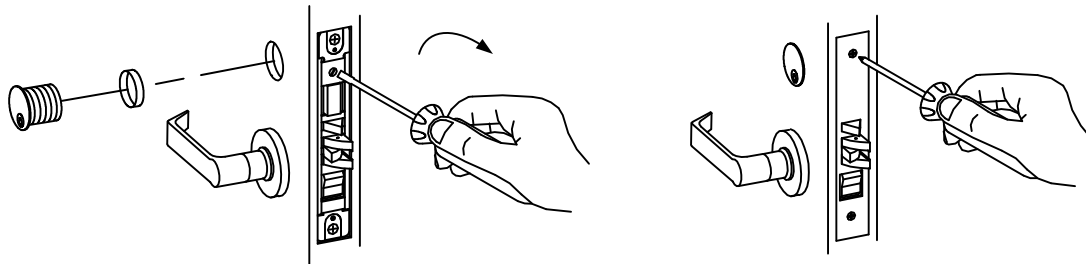
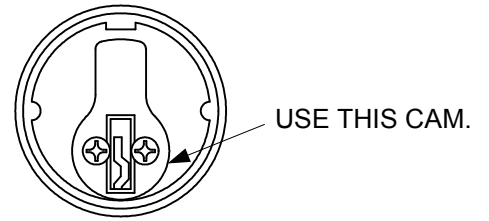

## G. Lock Wiring

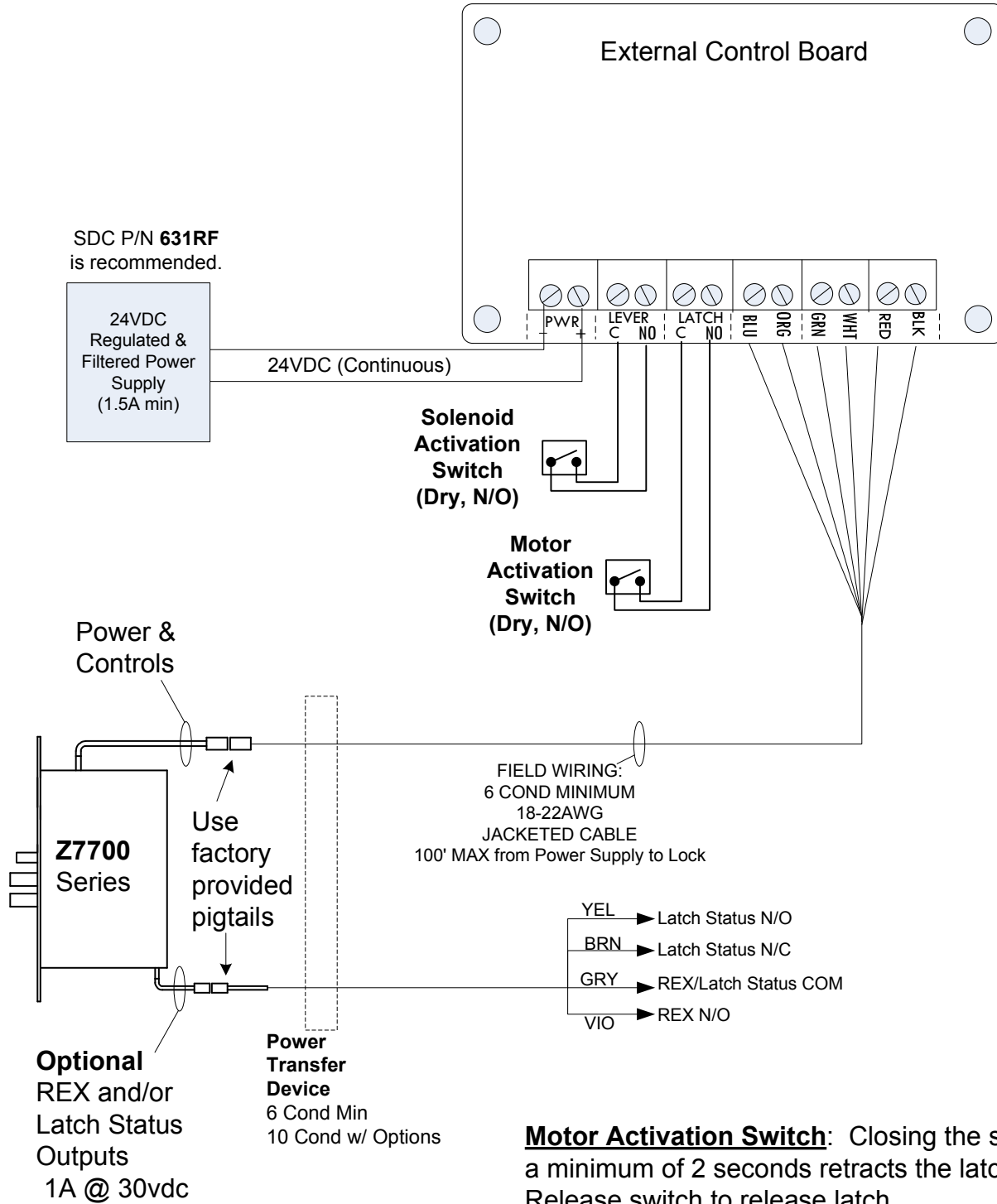

**Motor Activation Switch:** Closing the switch for a minimum of 2 seconds retracts the latch. Release switch to release latch.

**Solenoid Activation Switch:** Closing the switch will provide power to the solenoid. If the solenoid is fail-safe, activating the switch will lock the lever. If the solenoid is fail-secure, activating the switch will unlock the lever.

Make sure the lock hand matches the door hand, use the following diagram to determine the hand of door.

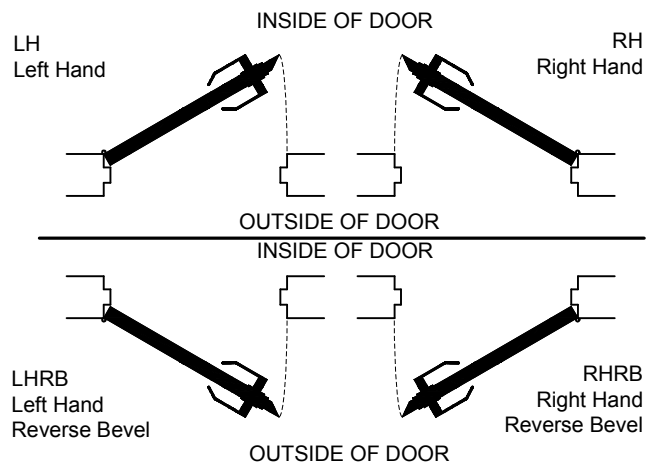

OPTIONAL  
DOOR CORE DRILLING GUIDE  
#7000-DG

